

D6 FROM D6-400 TO D6-440 STD INSTALLATION, RISER
 D4 AND D6 UP TO D6-380 STD INSTALLATION, RISER
 D4 AND D6 UP TO D6-380 OPTIONAL SHORT INSTALLTION, RISER
 D6 FROM D6-400 TO D6-440 STD INSTALLATION, STD EXHAUST BEND
 D4 AND D6 UPTO D6-380 STD INSTALLATION, STD EXHAUST BEND
 D4 AND D6 UPTO D6-380 OPTIONAL SHORT INSTALLTION, STD EXHAUST BEND

- (A) ANODE
- (B) ANODE (UNDER COVER)
- (C) OIL DRAIN (UNDER COVER)
- (D) WATER INLET
- (E) OIL FILL AND AIR VENTILATION PLUG
- (F) OIL FILTER (UNDER COVER)
- (G) OIL STRAIN (UNDER COVER)
- (H) LIFTING EYE, M10X1,5 ∇ 15 [0,59]
- X INSTALLATION DIMENSION

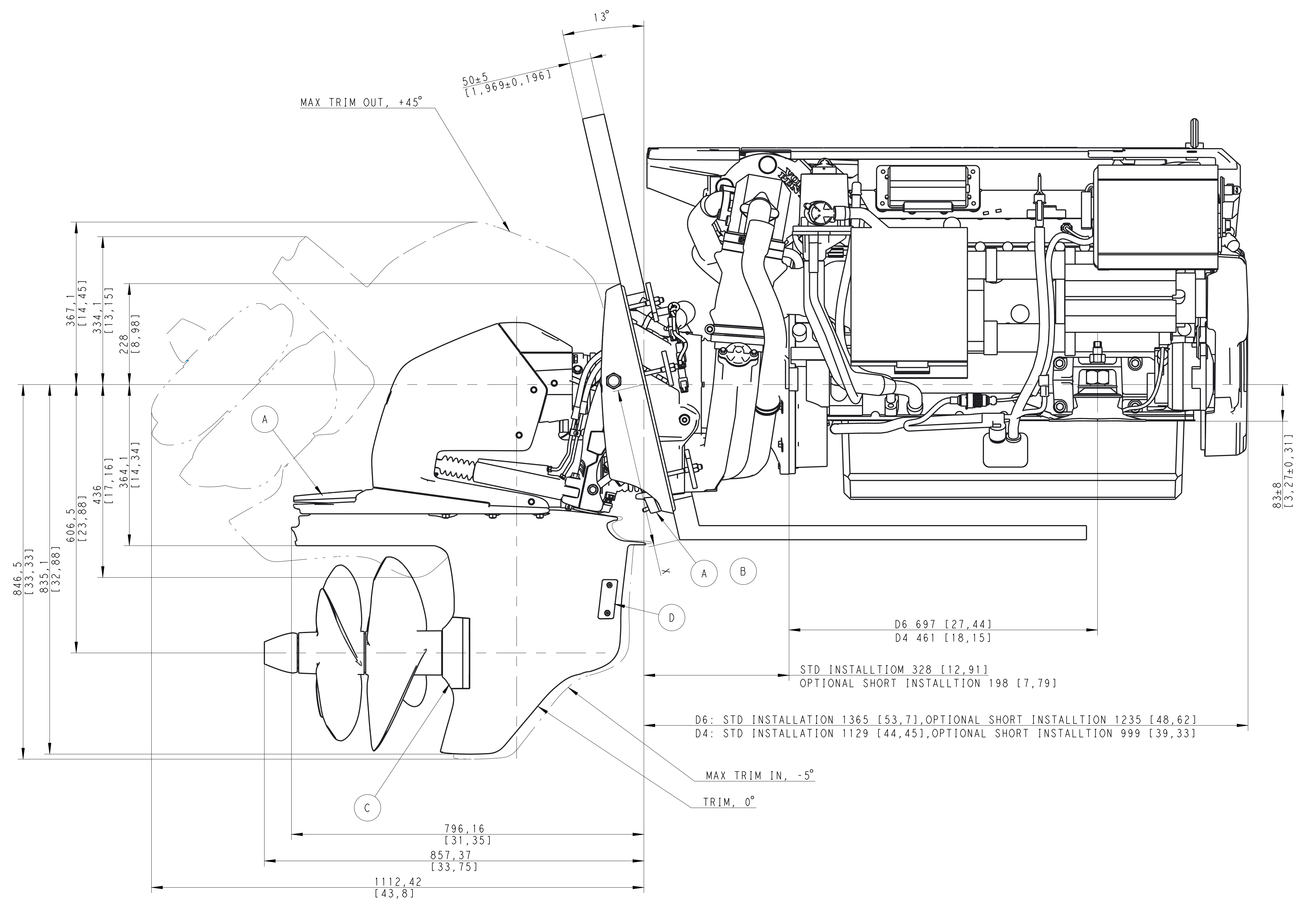
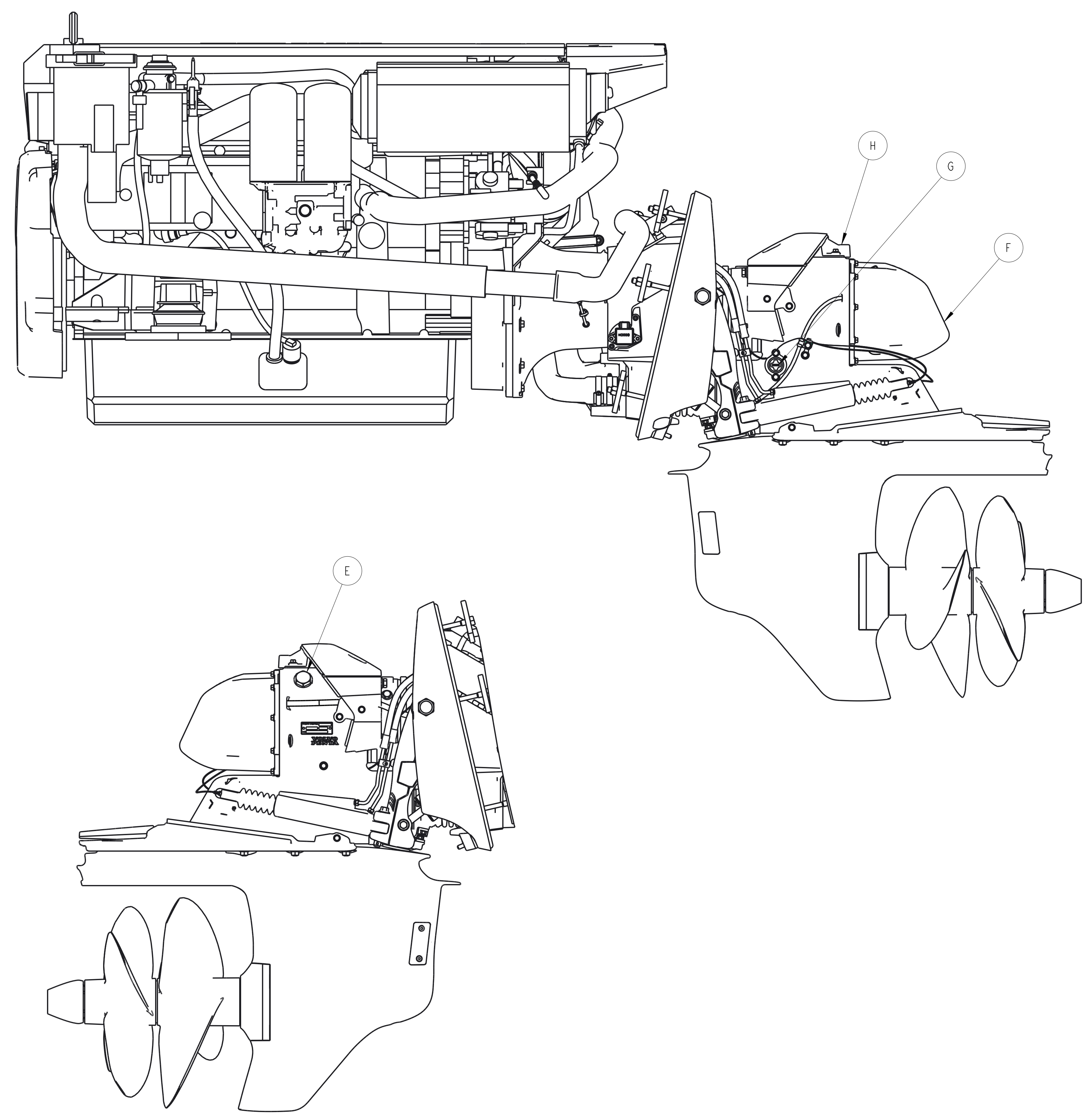

SHOWN ON THIS PAGE: D6 FROM D6-400 TO D6-440 AND STD INSTALLATION AND STD BELL HOUSING
 FOR ENGINE RELATED INFORMATION, SEE INSTALLATION DRAWING FOR ENGINE
 SCALE 5:1

The copying, distribution and utilization of this document as well as the completion of its contents is allowed without restriction in the private sector. Offenders are liable to the extent of the patent, utility model or trademark design registration.	SYMBOLS, DESIGNATIONS AND GENERAL DRAWING METHODS STD 101-0005		
	Document title INSTALLATION DRAWING D61, D4 & D6		
	Document type Over domain Document profile		
	Document No 23292847	Issue index 02	

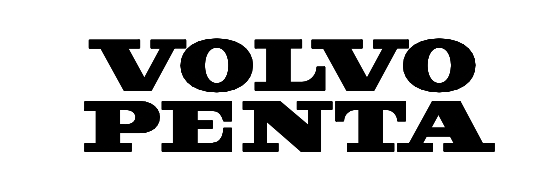

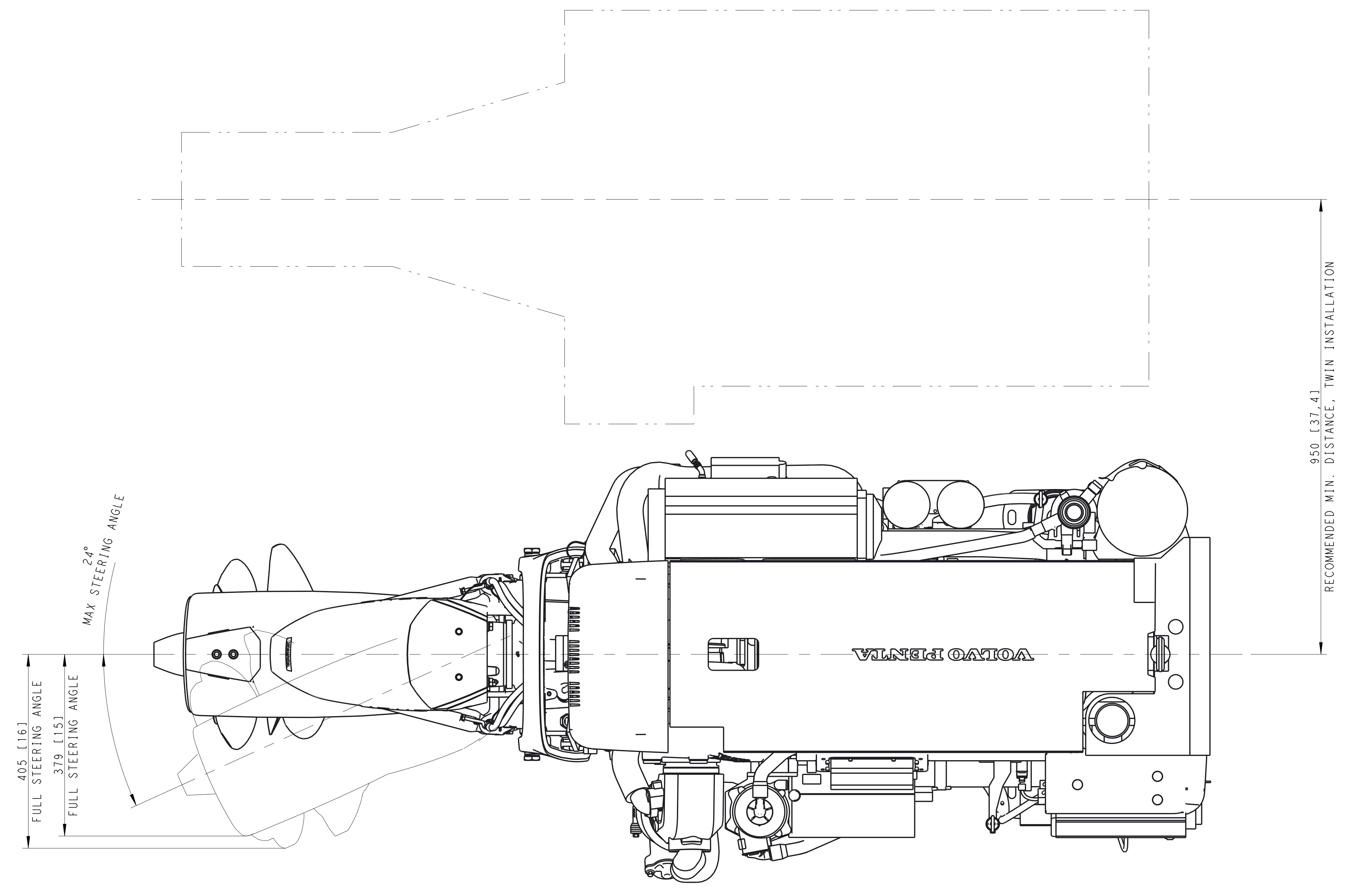
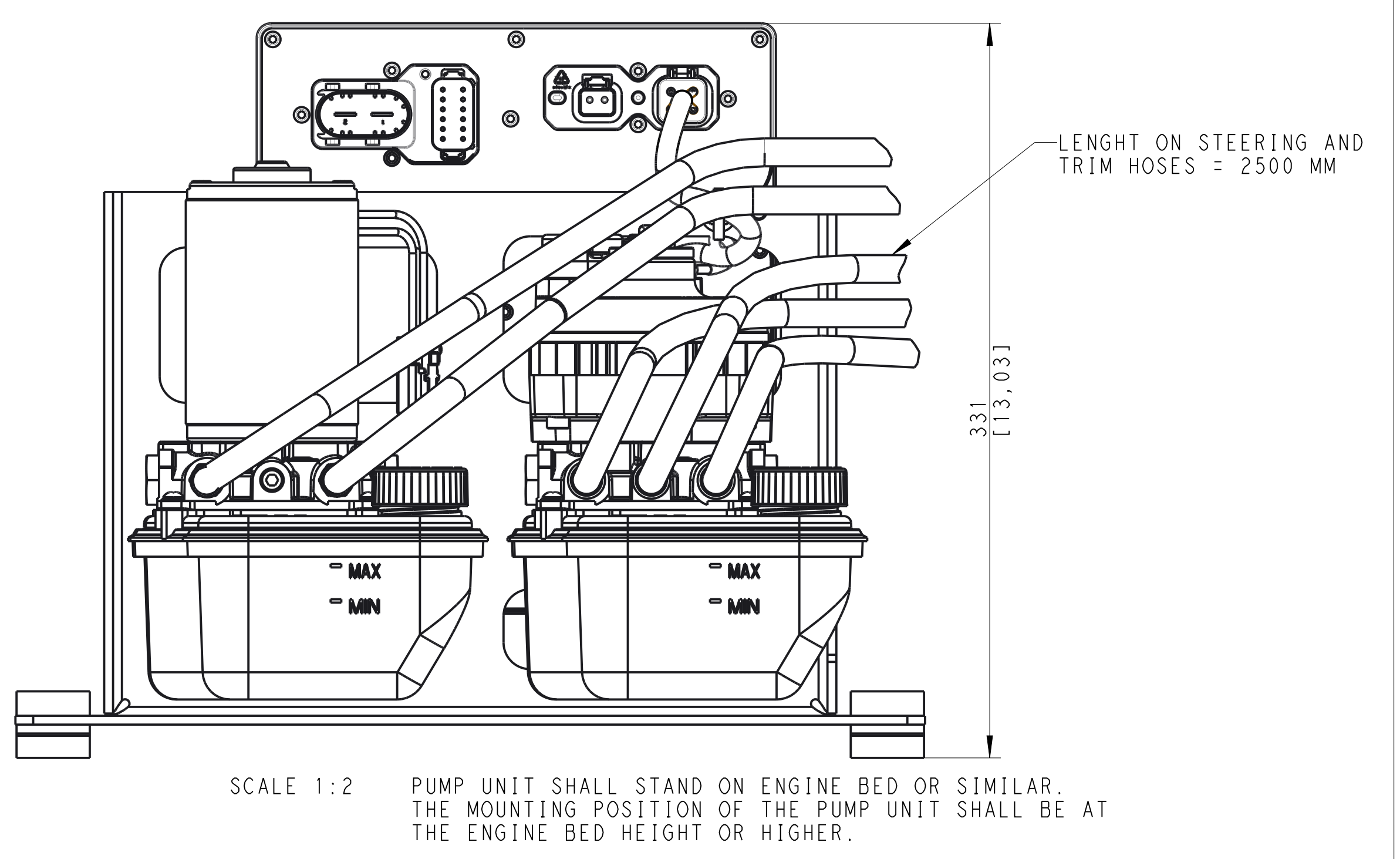
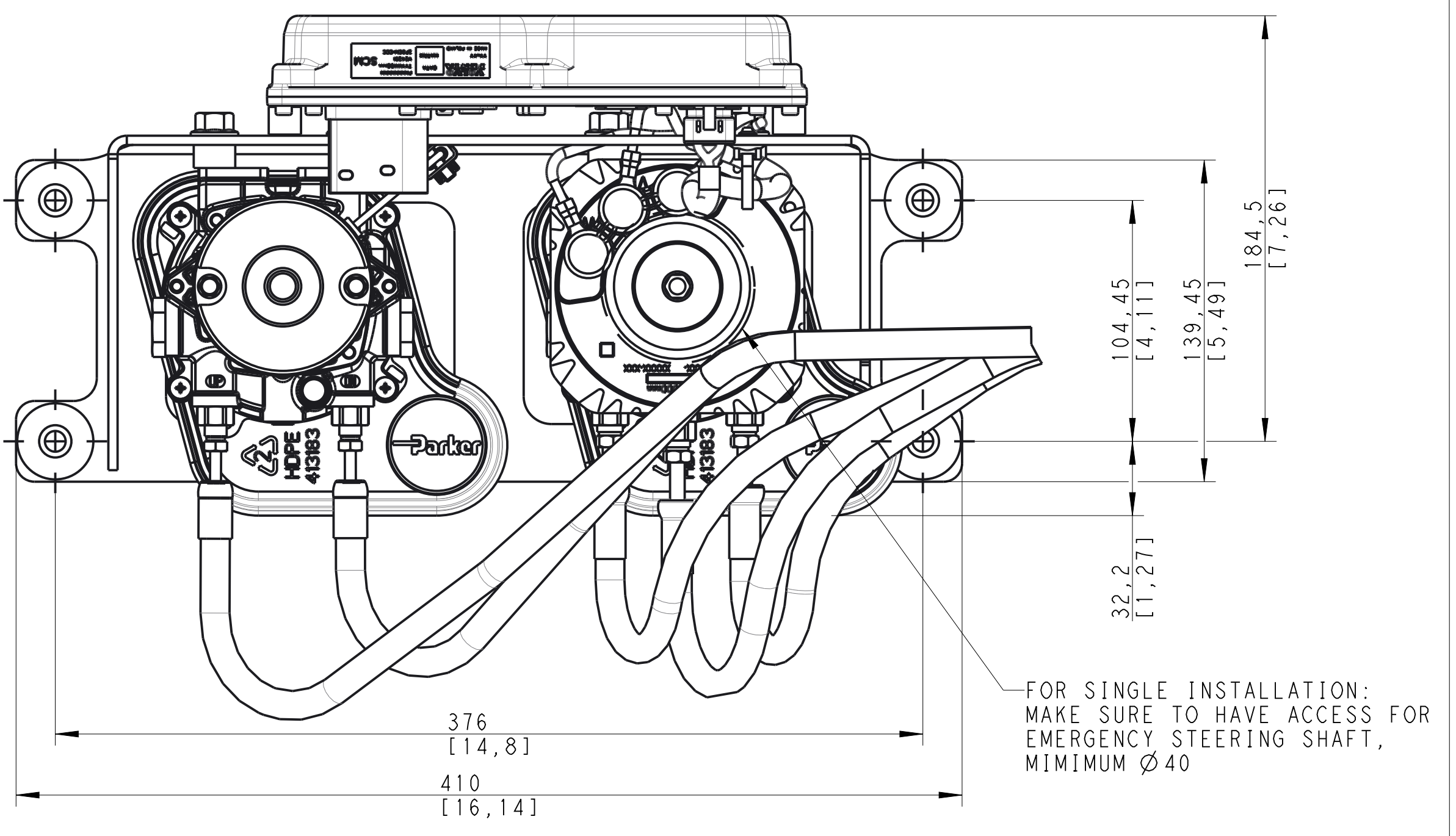

DPI WITH STD INSTALLTION

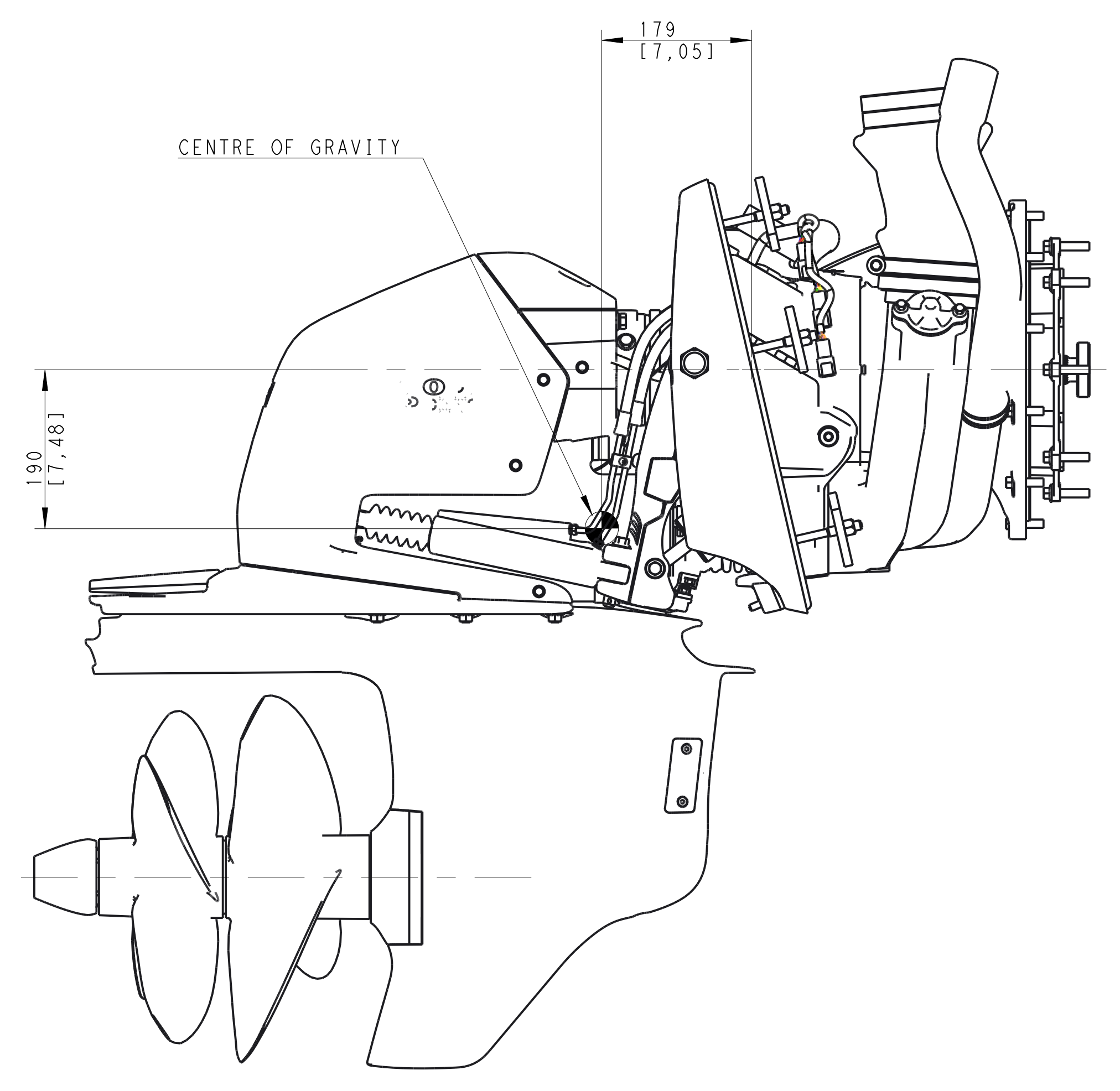

DPI WITH OPTIONAL SHORT INSTALLTION

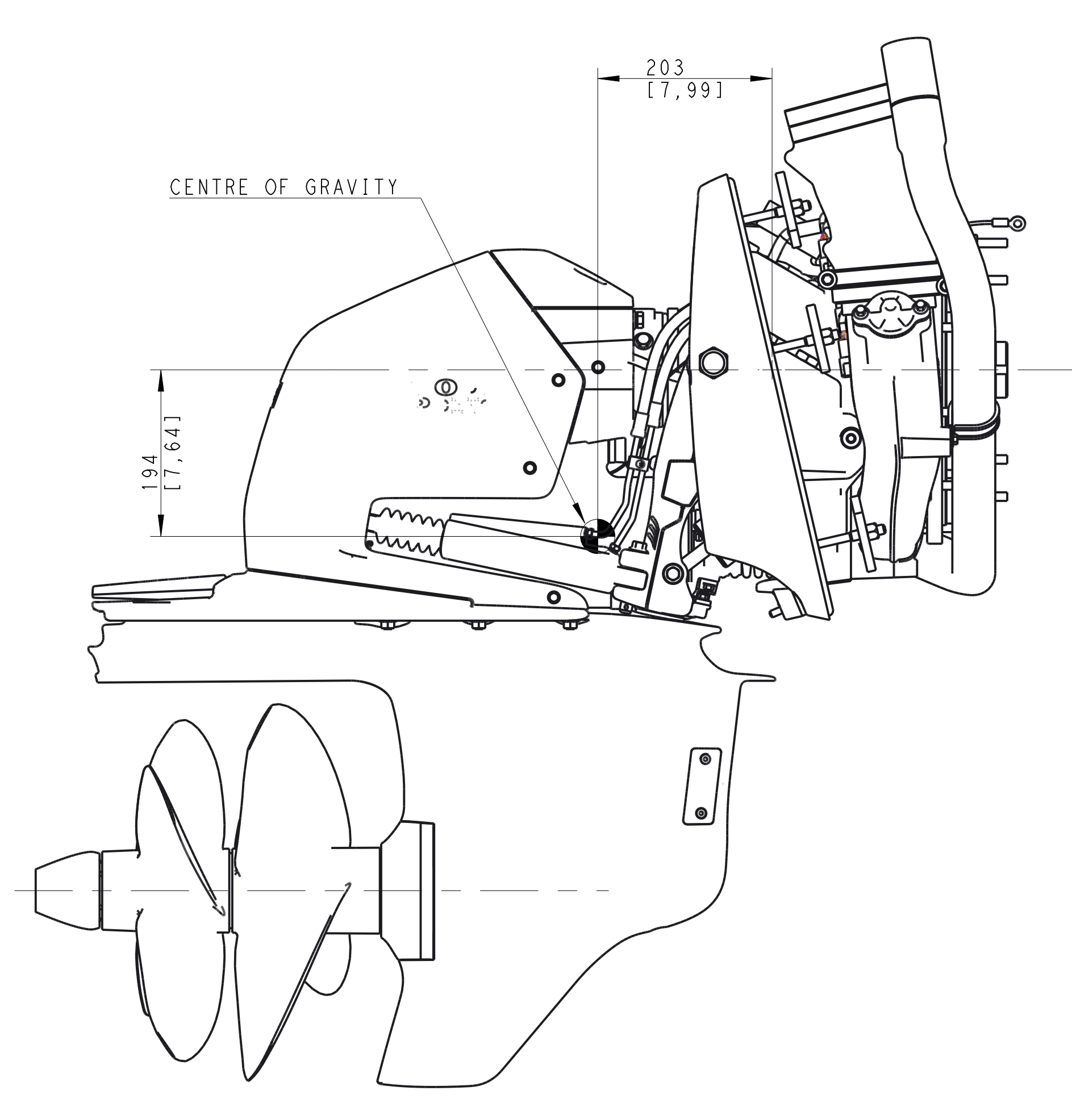

A - A

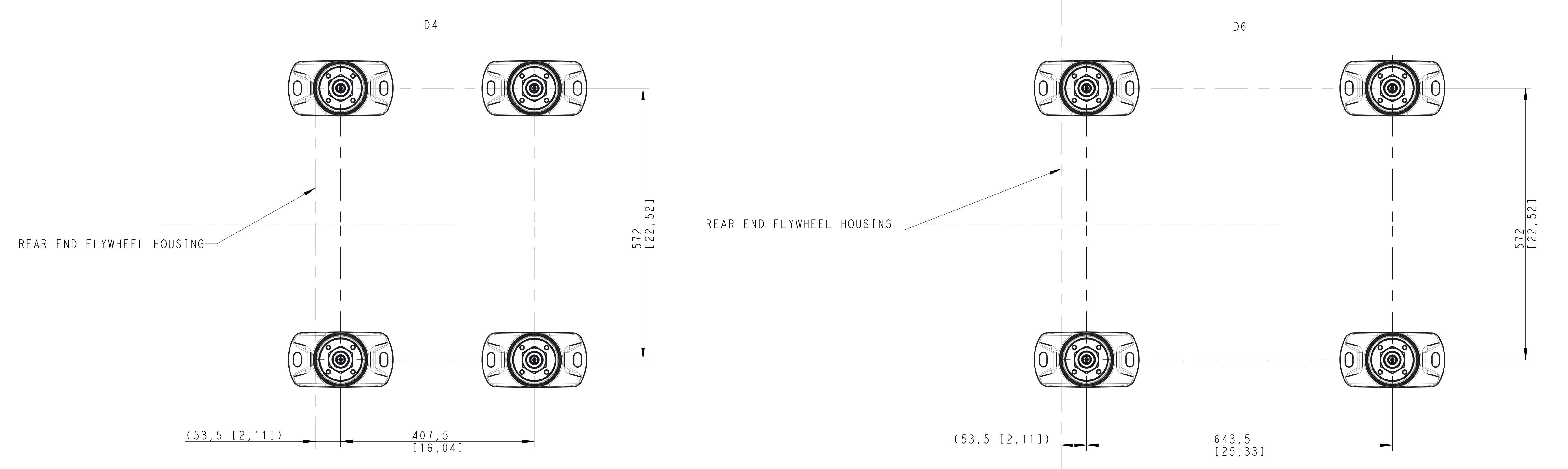
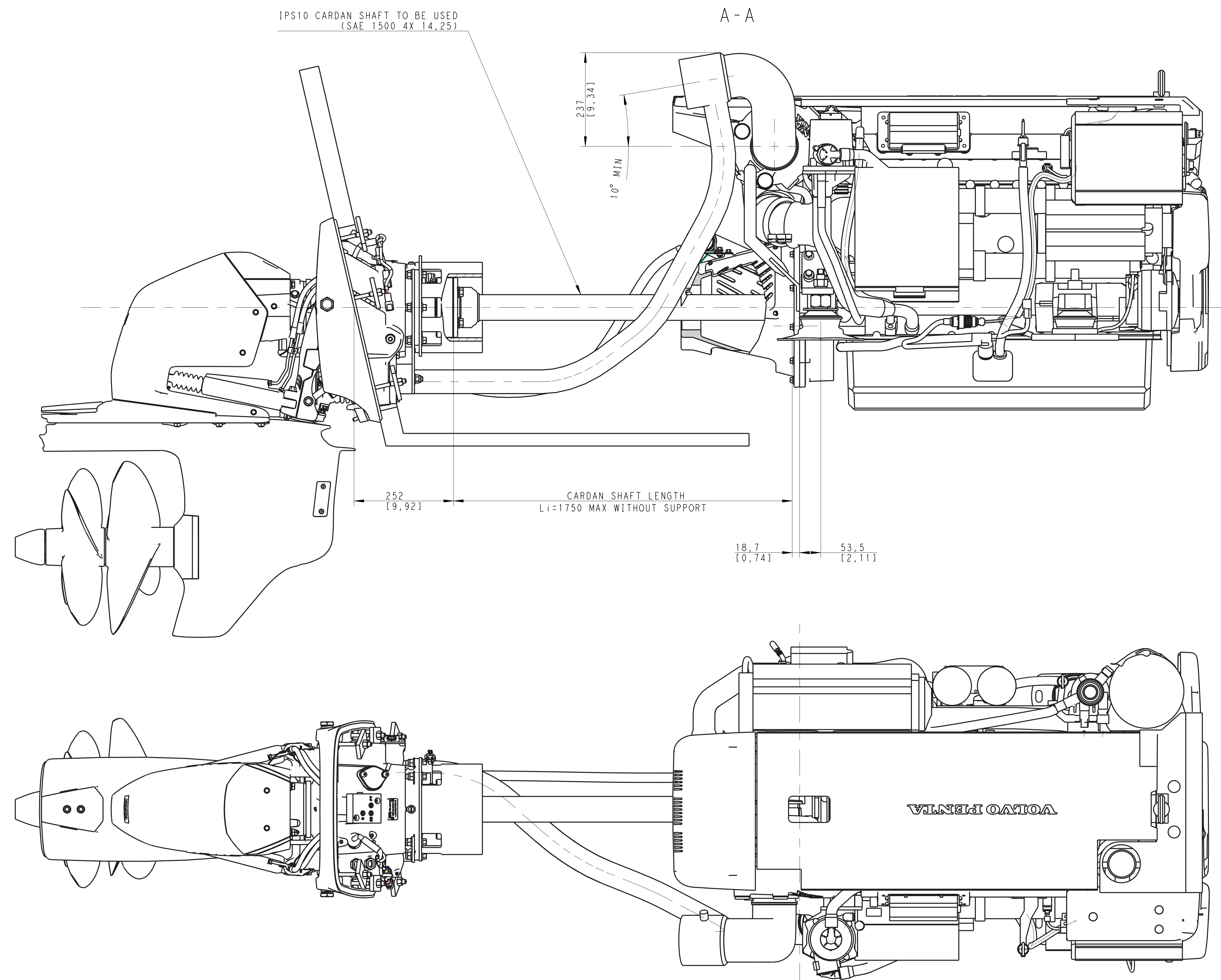

Engineering Release	Location	Change description	P/A: 0 - 4 Modified: NO	Document reference
Released		Issued: 01/88	D: 2 - 1 Modified: 000	RELEASED
				Date

SHOWN ON THIS PAGE: D6 FROM D6-400 UPTO D6-440
WITH JACK-SHAFT INSTALLATION AND RISER

<p>SYMBOLS, DESIGNATIONS AND GENERAL DRAWING METHODS STD 101-0005</p>		
<p>The copying, distribution and utilization of this document as well as the completion of its contents in other media is prohibited without the prior written consent of Volvo Penta AB. All rights reserved in the event of a patent, utility model or trademark design registration.</p>		
<p>Document title INSTALLATION DRAWING DPI, D4 & D6</p>		
<p>Document type</p>		
<p>Over domain Document prefix</p>		
<p>Document No 23292847</p>	<p>Issue index 02</p>	<p>Sheet No 3(5)</p>



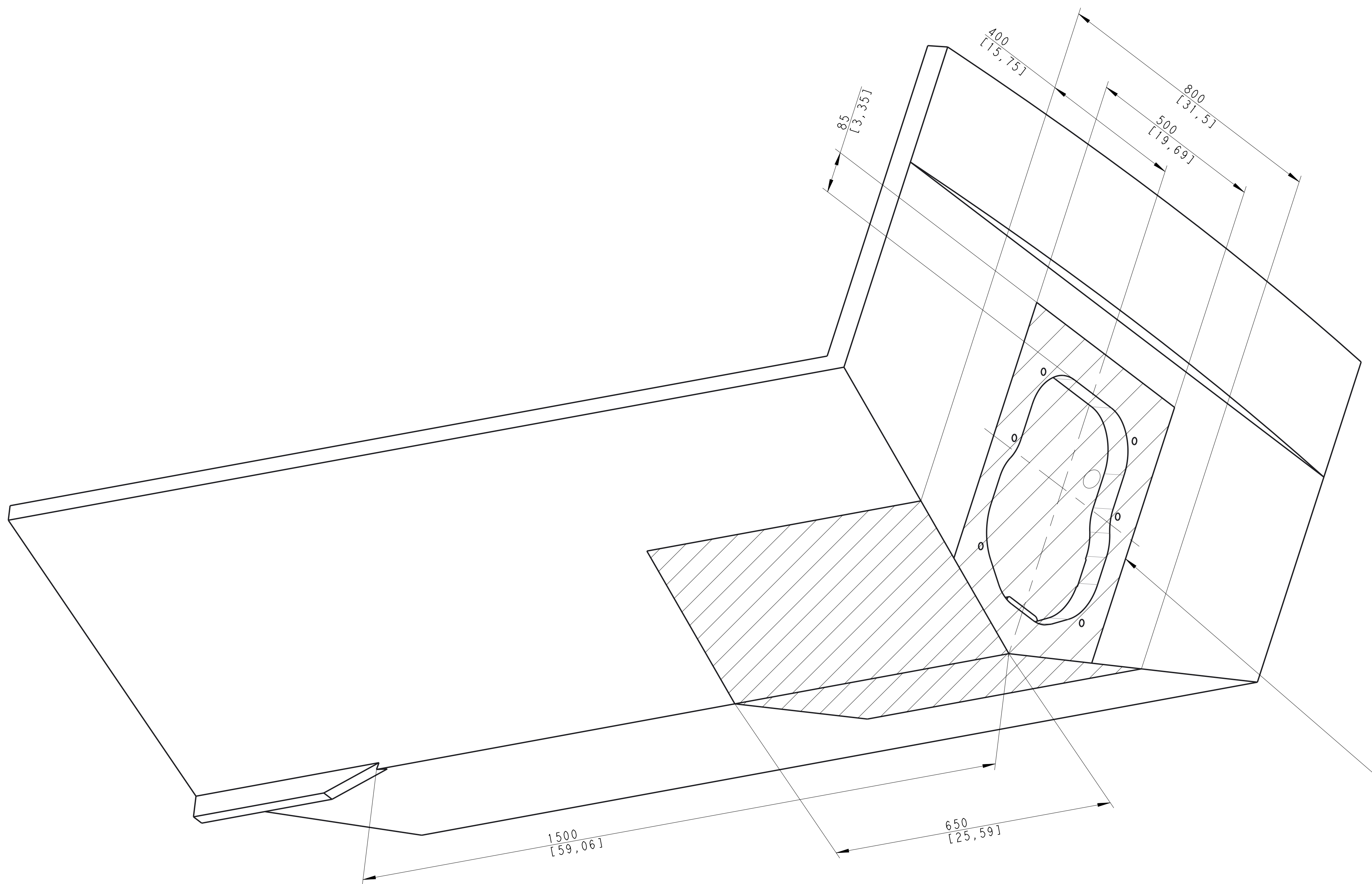

WITHIN THE MARKED AREAS
 THE INBOARD AND OUTBOARD TRANSOM SURFACES
 MUST BE PARALLEL (//) TO WITHIN ± 3 mm [0,12]

THE INBOARD TRANSOM SURFCAE MUST BE FLAT (\square) TO
 WITHIN ± 3 mm [0,12]. THE OUTBOARD TRANSOME SURFACE
 MUST BE FLAT (\square) TO WITHIN $\pm 1,6$ mm [0,063].

TRANSOM

MINIMUM DISTANCES FOR OBJECTS FORWARD OF THE STERNDRIVE
 THAT CAN CAUSE TURBULACE AHEAD OF THE PROPELLERS
 LOG AND ECHO-SOUNDER SENSORS, ETC. MAY NOT BE
 LOCATED INSIDE THE SHADED AREAS

KEELS, STRAKES, LADDERS, ETC. MAY NOT BE WITHIN
 1500 mm FROM THE TRANSOM.

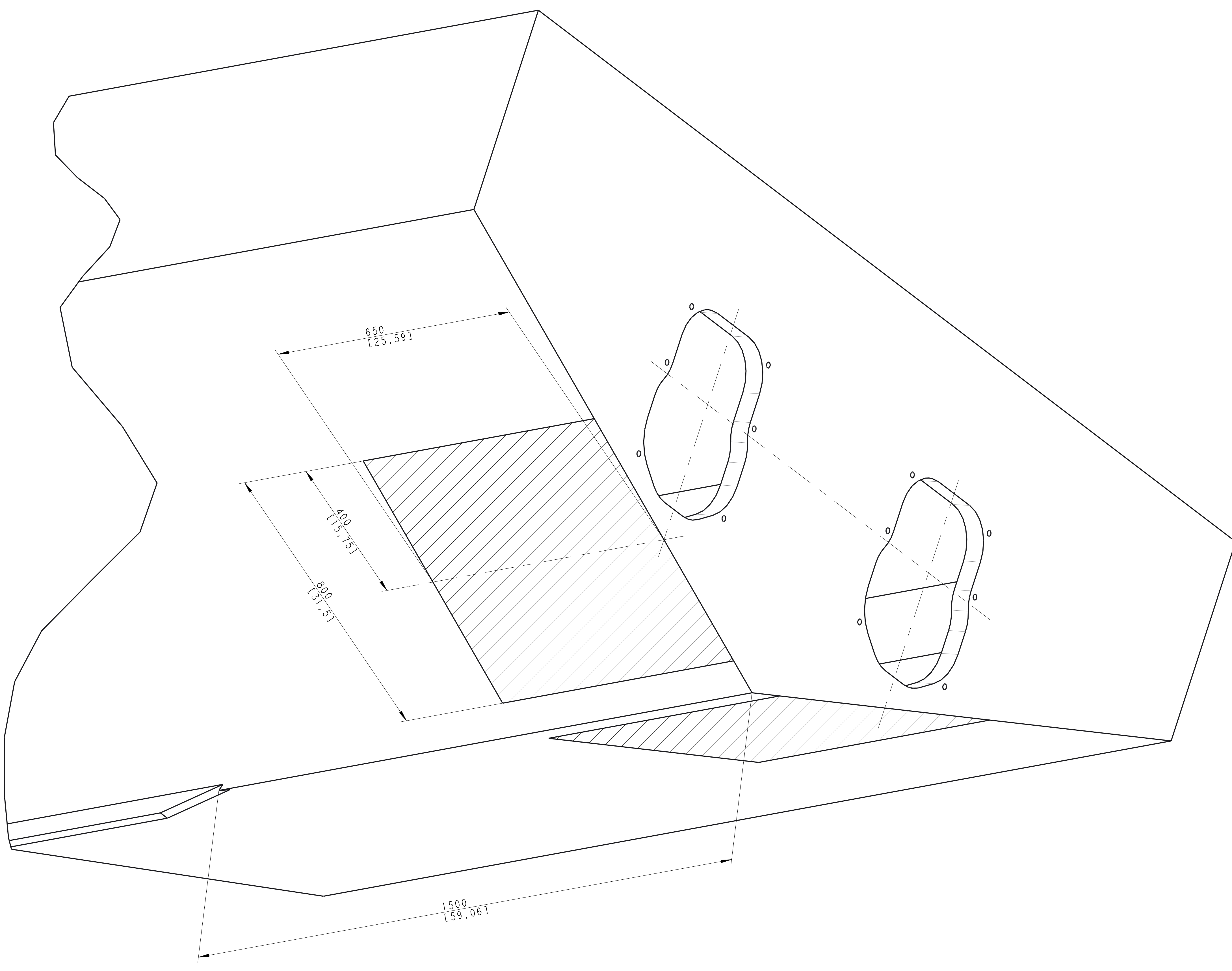

TWIN INSTALLATION
 CRITICAL AREAS MAY OVERLAP ONE ANOTHER DEPENDING ON
 THE DISTANCE BETWEEN THE ENGINES.